

Chicago Valves & Controls



SERIES 26

FULL PORT THREADED 2PC

BALL VALVE SEAL WELD

316 STAINLESS STEEL - ASTM A351 CF8M
CARBON STEEL - ASTM A216 WCB
2000 CWP (1/4"-2")
1500 CWP (2 -1/2"-3")
150 WSP
VACCUM SERVICE TO 29" Hg
NACE MR0175
LOCKING DEVICE HANDLES (LEVERS & OVAL HANDLES)
BLOWOUT PROOF STEM
ANTI-STATIC DESIGN

Series 26

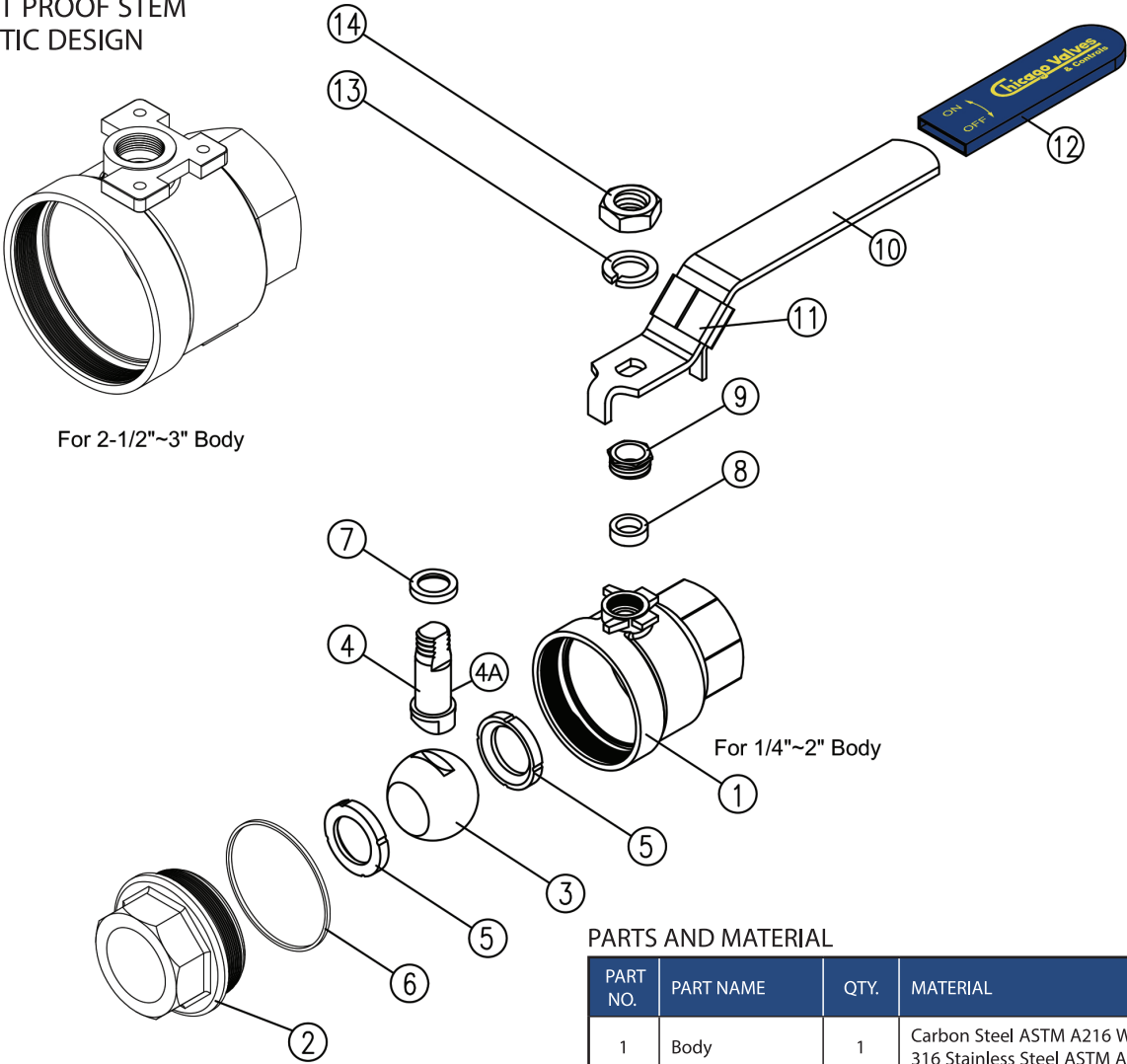

PARTS AND MATERIAL

PART NO.	PART NAME	QTY.	MATERIAL
1	Body	1	Carbon Steel ASTM A216 WCB 316 Stainless Steel ASTM A351 CF8M
2	End Piece	1	Carbon Steel ASTM A216 WCB 316 Stainless Steel ASTM A351 CF8M
3	Ball	1	316 Stainless Steel
4	Stem	1	316 Stainless Steel
4A	Anti-Static Ball	2	300 Series Stainless Steel Hard Drawn Stainless Steel
5	Seat	2	RTFE
6	Body Seal	1	PTFE
7	Thrust Washer	1	Carbon Fill PTFE
8	Stem Packing	1 Set	PTFE
9	Packing Nut	1	304 Stainless Steel
10	Handle	1	304 Stainless Steel
11	Locking Pad	1	304 Stainless Steel
12	Handle Sleeve	1	PVC
13	Spring Washer	1	304 Stainless Steel
14	Nut	1	304 Stainless Steel

Series 26

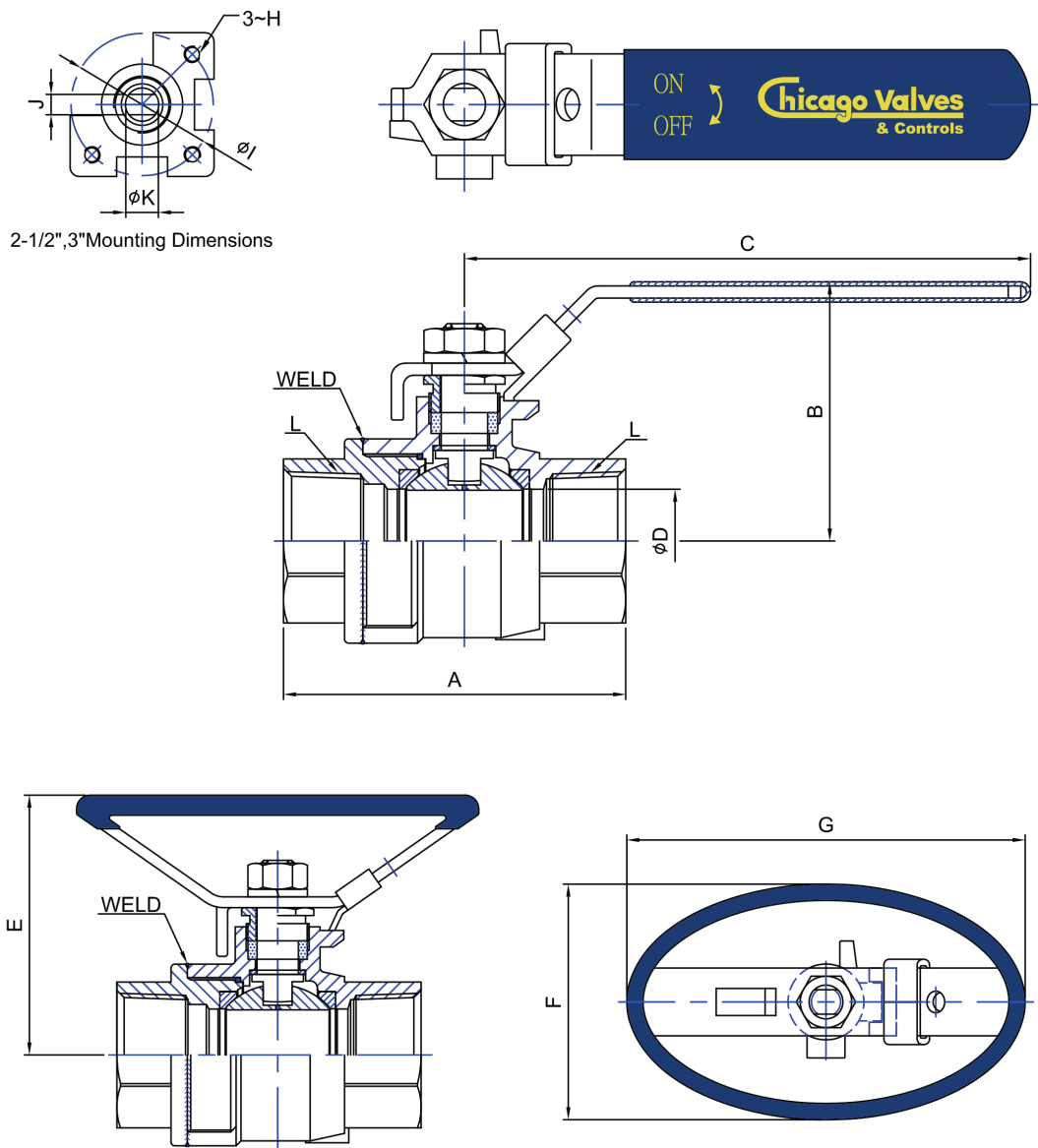

DIMENSIONS (INCHES)

SIZE	A	B	C	D	E	F	G	H	I	J	K	L	ISO5211
1/4"	2.20	2.20	4.20	0.45	2.55	1.95	3.45	-	-	0.20	0.30	NPT	-
3/8"	2.20	2.20	4.20	0.50	2.55	1.95	3.45	-	-	0.20	0.30	NPT	-
1/2"	2.40	2.25	4.20	0.60	2.60	1.95	3.45	-	-	0.20	0.30	NPT	-
3/4"	2.90	2.50	5.05	0.80	3.20	2.75	4.70	-	-	0.25	0.40	NPT	-
1"	3.35	2.60	5.80	1.00	3.35	3.55	5.95	-	-	0.30	0.45	NPT	-
1-1/4"	3.90	2.80	5.80	1.25	3.55	3.55	5.95	-	-	0.30	0.45	NPT	-
1-1/2"	4.40	3.35	7.50	1.50	4.48	4.15	6.65	-	-	0.40	0.55	NPT	-
2"	5.30	3.70	7.50	2.00	4.78	4.15	6.65	-	-	0.40	0.55	NPT	-
2-1/2"	6.60	5.50	9.85	2.55	-	-	-	M8X1.25	2.75	0.50	0.75	NPT	F07
3"	7.55	5.90	9.85	3.00	-	-	-	M8X1.25	2.75	0.50	0.75	NPT	F07

APPLICABLE STANDARDS

SHELL TEST	ASME B16.34
SEAT TEST	ASME B16.34
THREADED ENDS	ASTM B16.11

SIZE	CV (GPM)	WEIGHT (LBS)
1/4"	10	0.57
3/8"	10	0.53
1/2"	16	0.66
3/4"	32	1.06
1"	62	1.72
1-1/4"	115	2.60
1-1/2"	140	4.14
2"	365	6.92
2-1/2"	450	14.99
3"	1100	22.71

PRESSURE-TEMPERATURE RATINGS SERIES 26

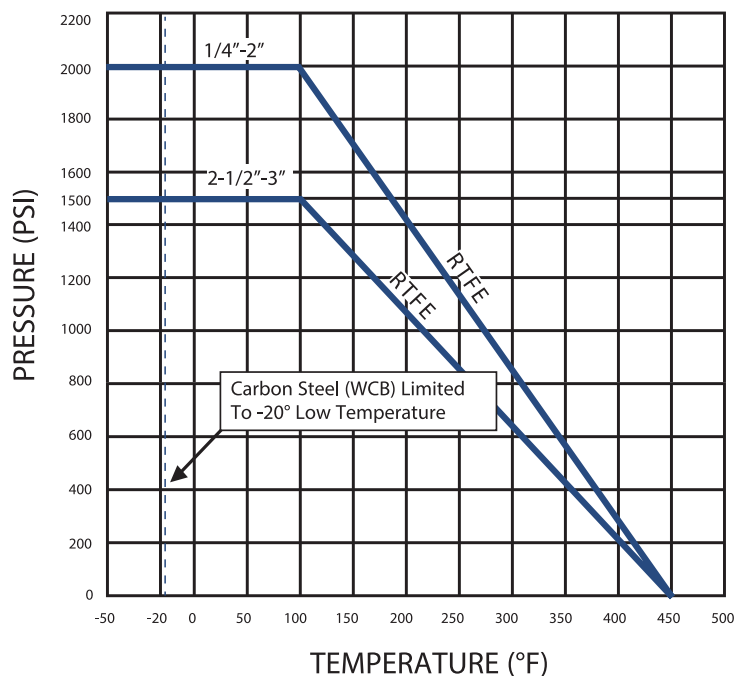

HOW TO ORDER

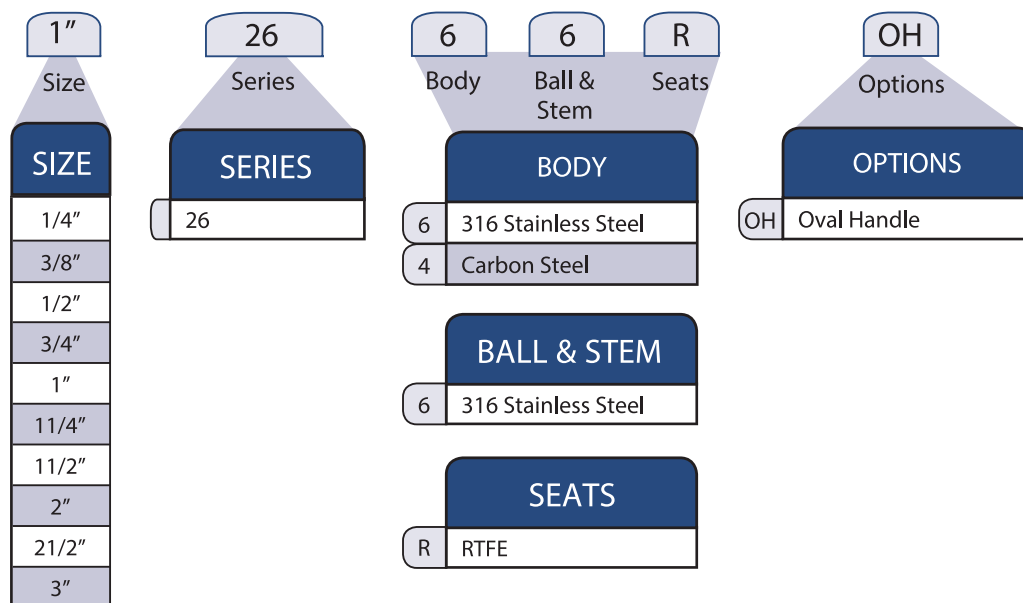

**Chicago Valves
& Controls**



Toll-Free (833) 831-2312

Local (312) 637-3557

Fax: (312) 637-3543

E-Mail: sales@chicagovalves.com

www.chicagovalves.com

885 Cambridge Dr.

Elk Grove Village, Illinois 60007 U.S.A.